

HDL[®]

The Product Design Manual

Building and Home Automation Control System

HDL-MWM70 Curtain Assembly

Contents

| | |
|---|----------|
| 1. Characteristic | 1 |
| 2. Notice | 1 |
| 3. Curtain Rail Accessories..... | 1 |
| 4. Install Effect Diagram..... | 2 |
| 5. Installation Steps..... | 2 |

1. Characteristic

- ◆ AC power input, make the operation more stable and reliable
- ◆ Built-in a new generation of clutch, system operating noise no more than 40dB
- ◆ The curtain's horizontal pull reaches 8KG, load capacity is 50KG
- ◆ Using HDL-BUS port as interface, DLP panel to control the curtain, easy to use

2. Notice

- ◆ Read all instructions in detail before use
- ◆ Non-Contact with the liquids or inflammable gas and object when using.
- ◆ Make sure there is no short-circuits or wiring errors before install
- ◆ Power off before install and uninstall
- ◆ When install the motor to the drive unit, please check and make sure that the latch has pushed into the locked hole, otherwise the motor will fall down to cause personal injury and product damage
- ◆ After the installation, please don't pull the curtain forcibly, don't put any additional weight on the curtain rail; please don't climb the curtain or hang anything on it; otherwise the rail and the motor will fall down then lead to personal injury and product damage
- ◆ Pay attention to water-proof, steam-proof, knock-proof
- ◆ Please use the dry cloth to wipe when cleaning, can't use the damp or corrosive stuff for wiping
- ◆ No overload used, or it will cause heating, and lead to burning or cause a fire
- ◆ Has any abnormal situation, please stop the operation and turn off the power, then contact with the technical service or our company

3. Curtain Rail Accessories



Hook Unit



Belt



Roller Runner



Fixture



Rubber



Ceiling Bracket



Insertion



Clamp



Master Carrier and its handle



6-core RJ11



Track Joiner



Motor



Motor Base Socket



Master



Slave



Drive Unit and Roller Runner



Drive Unit and Hook Unit



Motor Lock

The dimensions of ceiling bracket

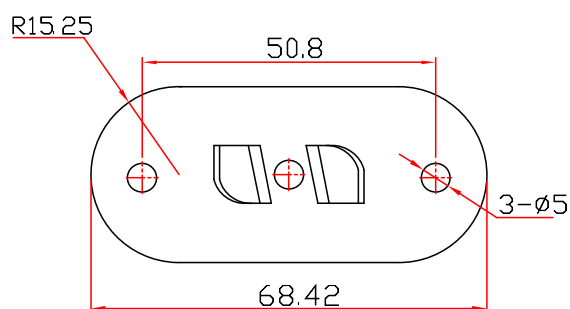

4. Install Effect Diagram

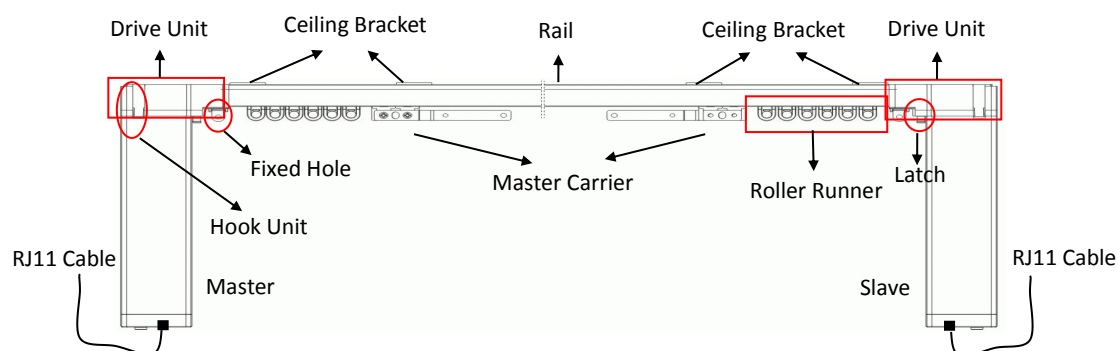

- The curtain hook mounting position:
Hook Unit→Fixed hole→Roller Runner→Master Carrier and its handle.
- Host、Slave:
Both host and slave are trietex, the host is connected to the HDL-BUS port and AC220V, and provides DC12V to the slave by the 6-core RJ11. The standard length of RJ11 wire is 1 meter.
- Ceiling Bracket's mounting distance:
From both ends to the middle rail, recommend to install one ceiling bracket per 600mm(cannot greater than 600mm); in the middle rail, the distance between ceiling bracket can be slightly long, the recommended distance is 800mm. (Due to the load in the ends is big, the mounting distance of ceiling bracket need to be short; the load in the middle rail is small, the distance of ceiling bracket can be slightly long)

5. Installation steps

- (1) The length of the rail and the belt need to custom-made according to the size of the window. If the length of the rail and the belt are too long, then need to cut. Rail cutting: both rails need to cut to the half length of the window.(Notice: this step is very important, don't cut disorderly)
- (2) Take out the belt, thread it into one of the rails, drag it to the drive unit, then pull it out. At the end of the belt, insert the clamp1, then plug the fixture1.



- (3) Adjust the position of the fixture1(as shown in figure), and insert the clamp2 to the other side of the belt, next to the fixture1.

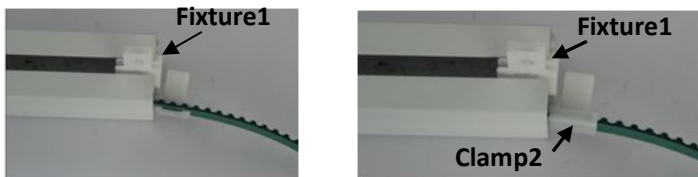

- (4) Adjust the belt's position, insert the clamp3 between the fixture1 and the clamp2, next to the clamp2.

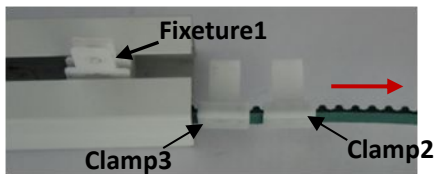

- (5) Adjust the positions according to the figure, put the master carrier1 onto the clamp2、3, its handle should point to the fixture1.

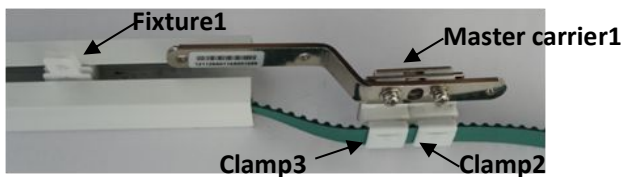

- (6) Thread the other side of the belt into the other rail, drag it to the drive unit, then pull it out. At the same time, push the master carrier1 into the rail.

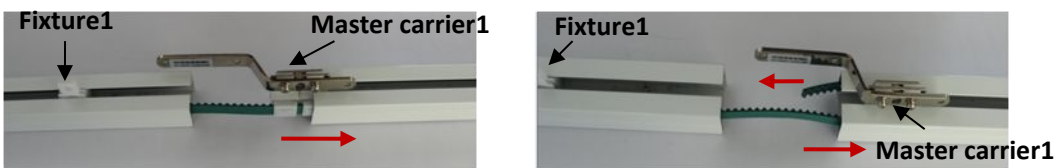

- (7) At the end of the belt, insert the clamp4, then plug the fixture2.

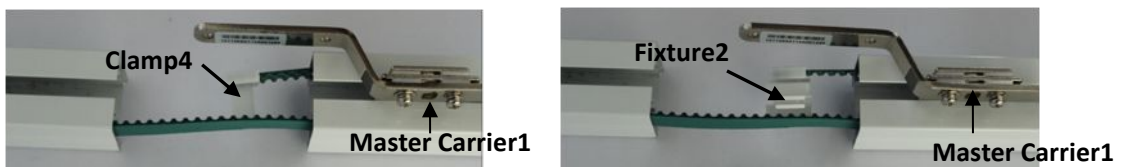

- (8) Adjust the belt, make the fixture1 and fixture2 closer, and place the rubber (the rubber can buffer the collision between two handles of the master carrier)

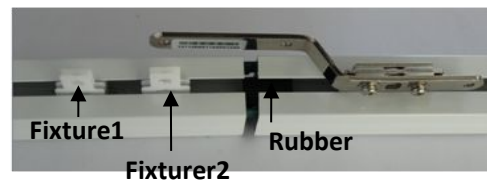
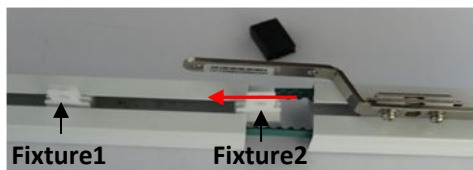

- (9) Insert an insertion between the fixture1 and fixture2, and install the handle onto the insertion, the handle should outward.

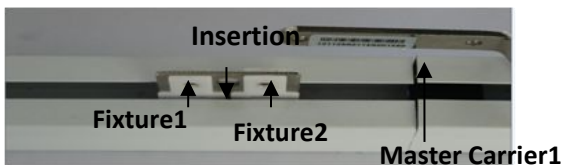

- (10) Face to the reverse side of the rail, adjust the position of the track joiner, make its middle part located in the gap of two rails, then outward stretch the rails with hands (Purpose: to let the belt running smoothly), meanwhile tighten the screws of the track joiner.

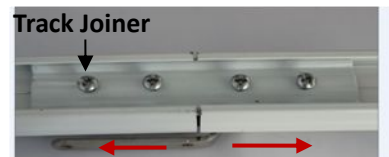

- (11) At the reverse side of the rail, can screw in more than one ceiling brackets, they are used for fixing the rail to the wall.

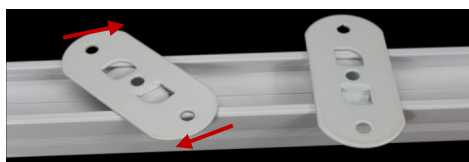

- (12) Screw the motor into the drive unit, then clamp tightly and lock it(Notice: the host motor should be installed to the side with the power supply; need to connect the host and slave by the 6 core RJ11, the standard length of RJ11 wire is 1 meter. Two plugs of the RJ11 have been pressed already, before use, need to connect

them together with a certain long network cable. Note that the RJ11 is a 6-core cable, if use the 8-core cable of RJ45 to connect, pay attention to the connection between the lines).



(13) Hang the hook unit on these two drive units(Notice: each drive unit has four optional places, the hook units make the curtain better to shield the window, as well as the motor, make it look beautiful). Install the curtain rail on the wall, and hang the curtain to the corresponding position. Finish the installation.

