

Features

HDL-MPT1.48, MPT2.48, MPT3.48, MPT4.48 multi-function control panel, embedded with RGB Led backlight for each touch button, any color is available for the button via setting in HDL Bus configuration tools software.

- Built-in IR receiver function
- Multi Key Mode : Single on-off, Singer on, Singer off, Combination on, Combination off, Combination on-off, Double click/singer on-off, Double click/combination on-off, Short/long press, Momentary, Short press/long momentary
- Multi Key control Mode : Scene, Sequence, Timer switch, Universal switch, Single channel on-off, Broadcast scene, Broadcast channel, Curtain, GPRS control, Panel control, Alarm control, Music play, Universal switch
- Adjustable backlight color and intensity
- Support upgrade firmware from HDL Bus
- Customized image for touch panel

Important Notes

- Real product may be different from drawings in the right photo
- Touch performance - touch panel sensitivity need to be readjusted after installation
- IR receiver function – only available for customized touch panel with IR receiving hole
- The Cover can be replaced by another cover by user
- Bus cable - CAT5E or HDL Bus/KNX Cable
- BUS connection - series connection (Hand-by-Hand)

Product Specifications

- Power supply (provided by HDL - MPPI.48) : DC12-30V
- BUS power consumption : 20mA/DC24V
- Installation: 86*86 GI Back Box
- Dimension : 86mm×86mm×10.5mm
- CE verification
- Working Temperature : 0~45°C
- Working Relative Humidity : 20%~90%
- Storage Temperature : -40°C~+55°C
- Storage Relative Humidity : 10%~93%
- IP Protection : IP20

HDL-Bus Definition for cable

Bus	HDL Bus/KNX Cable
COM	Black
DATA-	White
DATA+	Yellow
DC24V	Red

Type

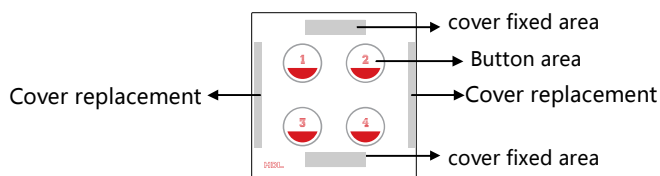
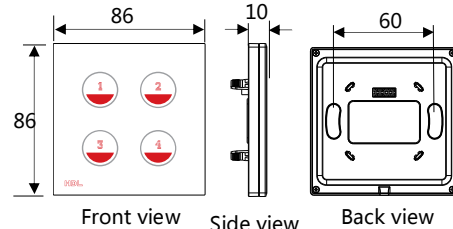
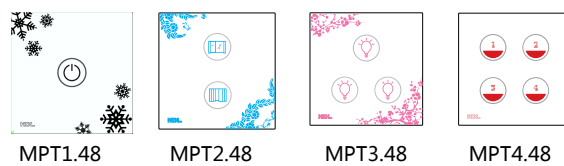

Touch button function: on/off, dimming

Address modification : keep pressing any of button for 15s, all the backlights will flash, the address of this device can be changed by using HDL-Bus software: Submenu "address management→address modify"

Glass plate replacement: use a small size straight screwdriver insert into the gap of the left side or right side of glass cover(see above cover replacement schematic), to pick up the glass cover, then put the new cover in right place , then press cover fixed area to lock the cover

Installation steps

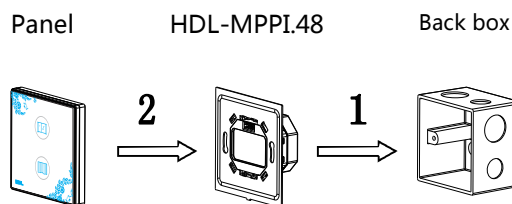

Remove the panel: use a straight screwdriver insert into the "Split fastener" to separate cover and power supply base (MPPI.48)

