

## Features

HDL - MPPI.48 Panel switch Power Docking Base provide the DC power and communicate signal for the panel switch, it supports different new generate on wall mount switches and wall mount new sensors.

This docking base is a General base for different switches, it has the HDL-Bus interface, 4 color defined plugs for connection. very easy for installation.

## Important Notes

- **Bus cable** - HDL Bus/KNX (0.8mm core)
- **Bus connection** -Recommend connection of Bus wire hand by hand
- It must work with other panel switch and sensor.

## Installation Steps

- Mount the HDL-MPPI.48 in the wall-box
- Make sure the Bus cable type is correct and has no circuit short
- Connect bus cables. Make sure the color of wire same as definition
- Put other device into HDL-MPPI.48

## Product Specifications

- Bus Power Supply : DC24V
- Mounting position: Standard GI Box
- Dimension : 86mm×86mm×30.5mm
- Communication interface: RS485
- CE approved
- Working Temperature: 0℃ ~ +45℃
- Working Relative Humidity: 20% - 90%
- Storage Temperature: -40℃- +55℃
- Storage Relative Humidity: 10% - 93%
- IP Protection : IP20

## Types

HDL-MPPI.48

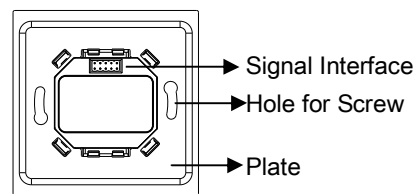

Signal Interface : To be connected with the panel switch or sensor.

Hole for Screw : Fix the Docking base into the back box.

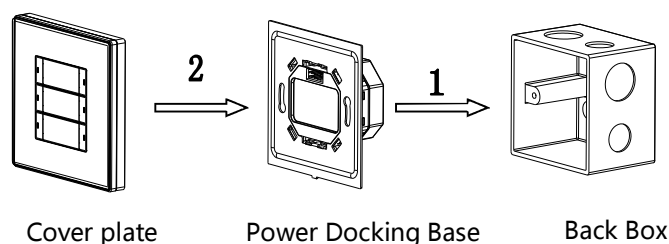
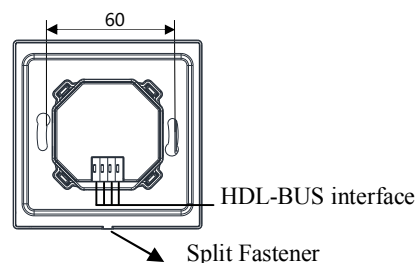

## Safety Attention

- Do not make wrong connection on Bus interface, it will damage the Bus interface of this interface module
- Avoid the rain or water into module, it will damage this device
- Do not get AC220V voltage into Bus wire , it will damage all of devices in system